

WESTCOTT 3000



With dual side opening doors and brushed steel handles, this radiant wood fire will make a statement in any room. Designed in New Zealand.

- Comfortably heats small to medium sized areas
- Cast-iron construction with cooktop, grate and ashpan
- Airwash system to maintain clear door glass

MODEL	WESTCOTT3000
FINISH	Black
FIREBOX	Cast Iron
APPROX. HEAT AREA	150m ²
EMISSIONS	1.5g/kg
EFFICIENCY	65%
DIMENSIONS (WxDxH)	652 x 356 x 640mm
FIREBOX DIMENSIONS (WxDxH)	520 x 245 x 300mm
ESTIMATE PEAK OUTPUT	12kW
LOG SIZE	500mm

Clearance Required To Combustible Materials

Minimum distance to heat sensitive materials (mm) when a flue deflector is fitted, and floor protector sizes as per standard AS/NZS 2918:2001.

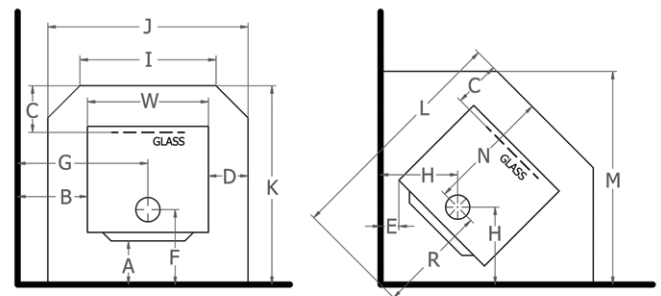

FLUE SHIELD	A	B	C	D	E	F	G	H	I	J	K	L	M	N	R	W
FUL: Flomet Universal Flue system with Masport double flue shield.	350	450	300	143	200	458	770	503	625	925	988	1241	1098	530	711	652

For detailed specifications please refer to installation manual.