

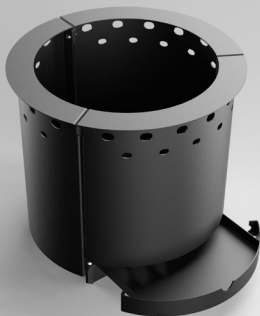

MAWSON
ONE

ASSEMBLY & USAGE INSTRUCTIONS

MMOFP



MMOFP
(MAWSON ONE FIRE PIT)



**Australian
Home Heating**
Association Inc.



**Landcare
Australia**

Glen Dimplex Australia proudly supports the activities of Landcare Australia through its membership of the AHHA.

VERSION 1.0

CONTENTS OF BOX

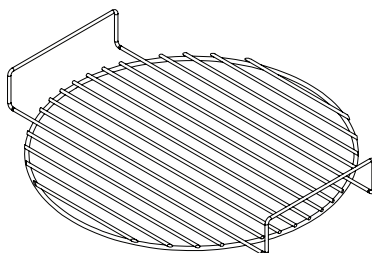
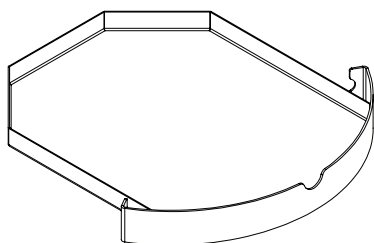
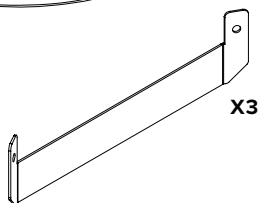
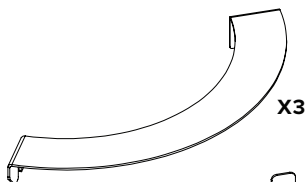
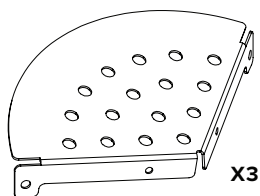
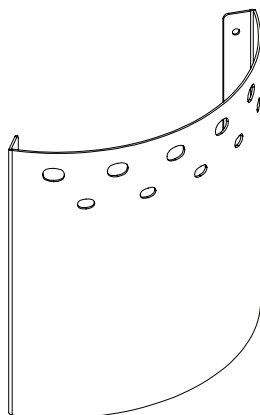
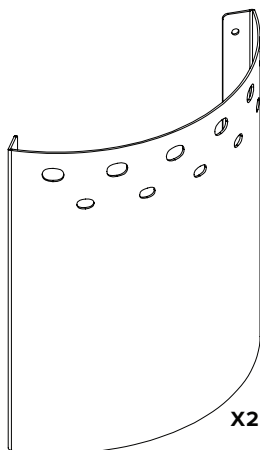

FASTENERS

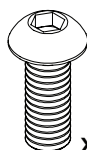

SAFETY INSTRUCTIONS

Caution! Do not touch any part of the fire pit with bare hands when the fire is lit. Mawson One gets very hot when in use. Please ensure children and pets are kept under supervision when the fire pit is in use. Do not leave the fire pit unattended when in use.

Caution! Mawson One is not designed for use on combustible surfaces, such as a wooden deck, dry grass, or bark chips. Ensure the fire pit is only ever lit on level noncombustible surfaces, such as concrete, sand or gravel.

Caution! Ensure that there is a safe distance between the fire pit and any combustible objects or materials. Do not use under outdoor structures such as pergolas.

Do not use alcohol, kerosene, gasoline or other flammable accelerants to light or relight the fire pit.

Do not over fire or abuse as this will impact the longevity of the fire pit.

NEVER use indoors. For outdoor use only.

USAGE TIPS

The Masport Mawson One Fire Pit is designed in Australia and made from high quality materials, and with proper use and care should last a considerable amount of time. To ensure the best possible experience with Mawson One, please follow the below usage tips:

Mawson One has been carefully designed to maximise airflow to the coal base. This makes it is easy to light and minimises the amount of smoke produced. To ensure optimum performance, don't load wood above the rim of the fire pit.

Good quality, dry fuel will result in the best low smoke performance. We recommend using smaller pieces of properly seasoned hardwood. Do not burn wet wood.

The painted components of Mawson One are finished in a heat resistant metallic black finish. The first time the fire pit is lit, it may give off some odorous fumes. This is caused by the paint curing. Once the paint has cured it will not re-occur.

You can cook on Mawson One using the included cooking grill. We recommend waiting until your wood has burned down to a bed of red hot glowing coals for optimum cooking performance. Before the first use, clean the grill with warm soapy water. Do not cook over the fire pit during the initial burn while the paint is curing.

Wait until the fire has gone out completely and the unit is cool to the touch before attempting to clean out remaining ash and coals. Remove the ash tray and dispose of ash in a bin. We recommend then using a suitable hand broom to brush any remaining loose ash and coals from the inside of the fire pit into a bin.

Keep Mawson One in a dry place when not in use, to protect it from the elements.

ASSEMBLY INSTRUCTIONS

1

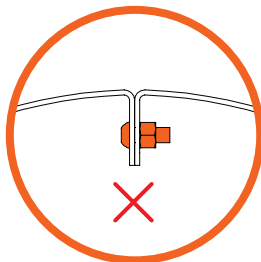
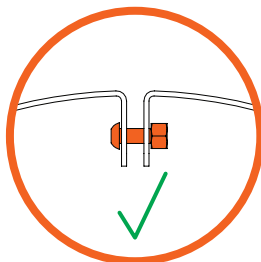
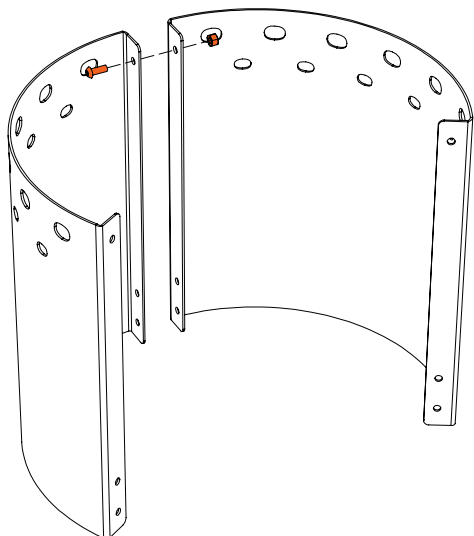

2

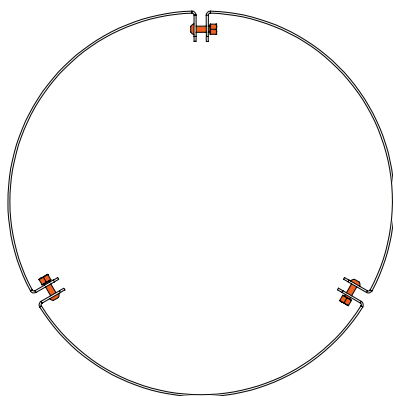
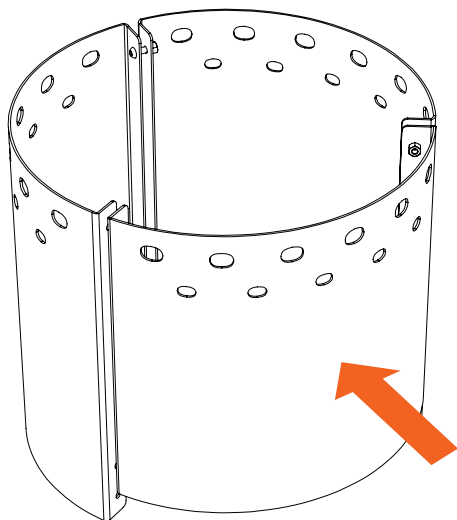

3

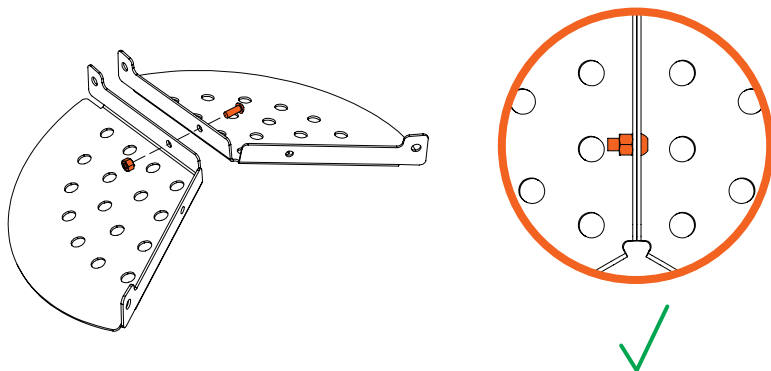

4

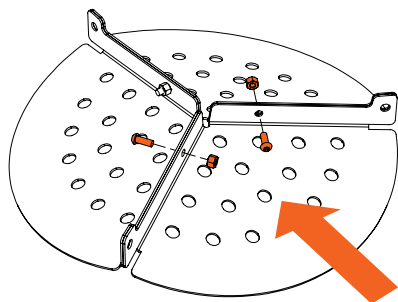

5

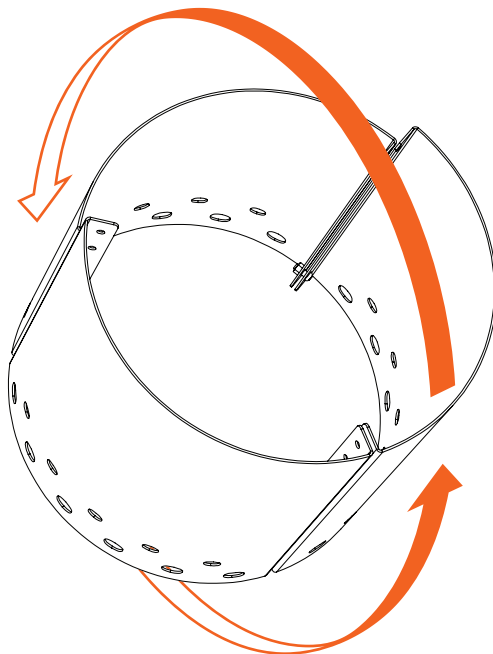

6

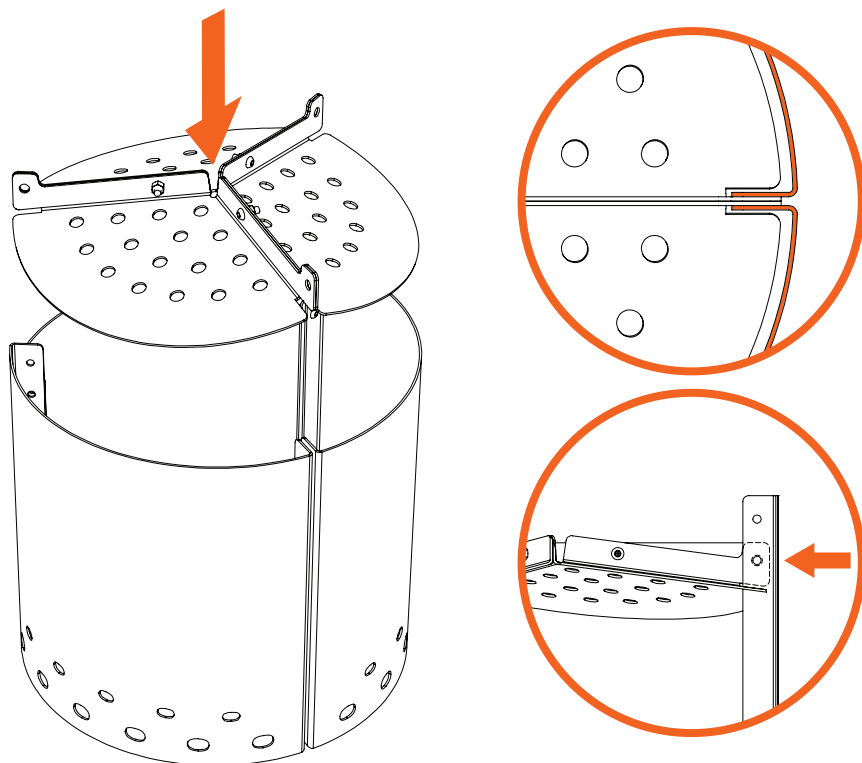

7

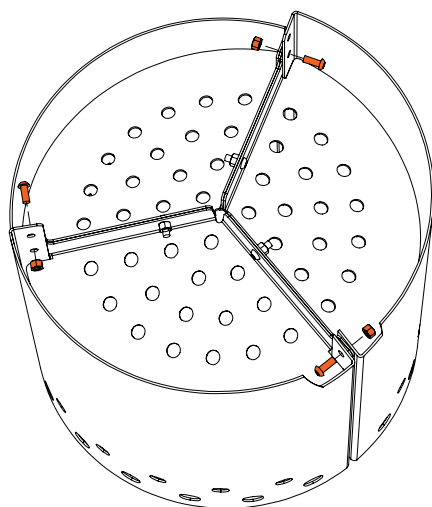

8

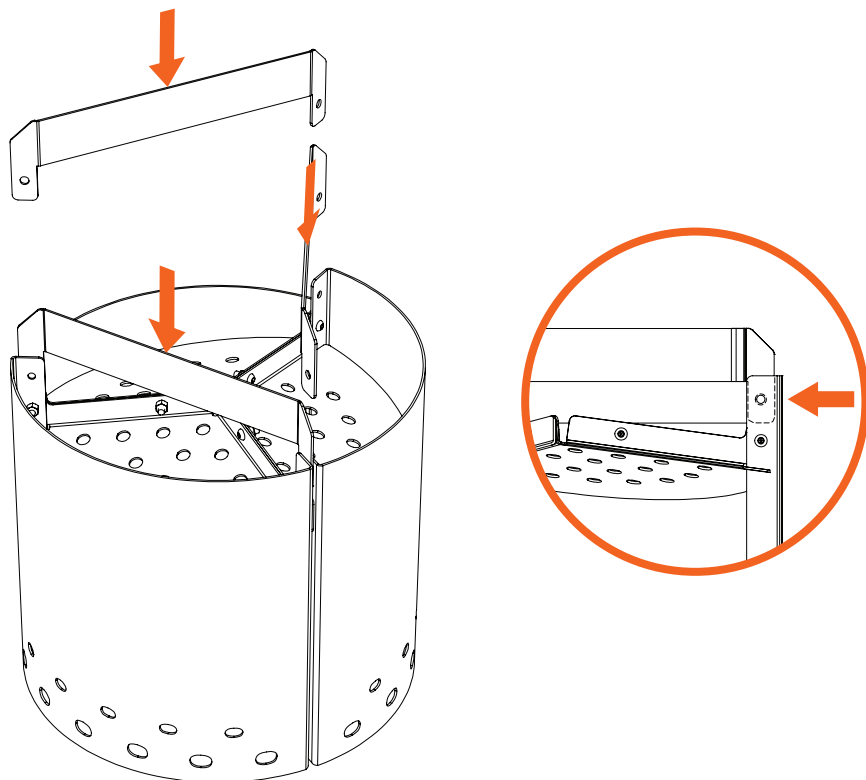

9

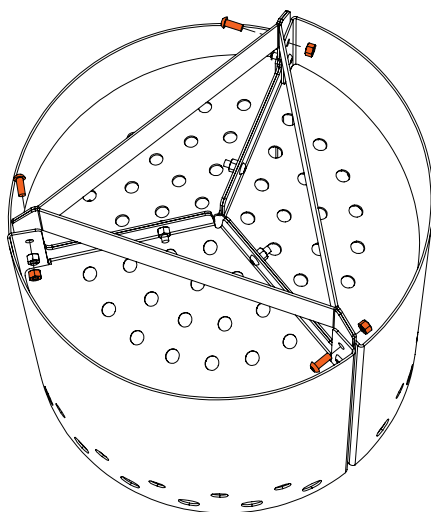

10

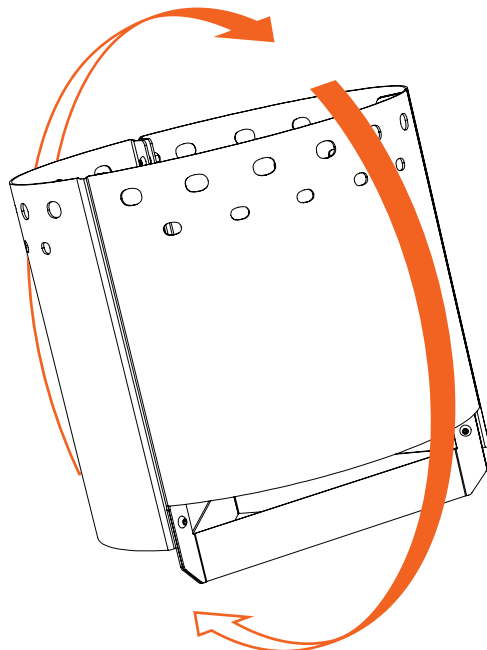

11

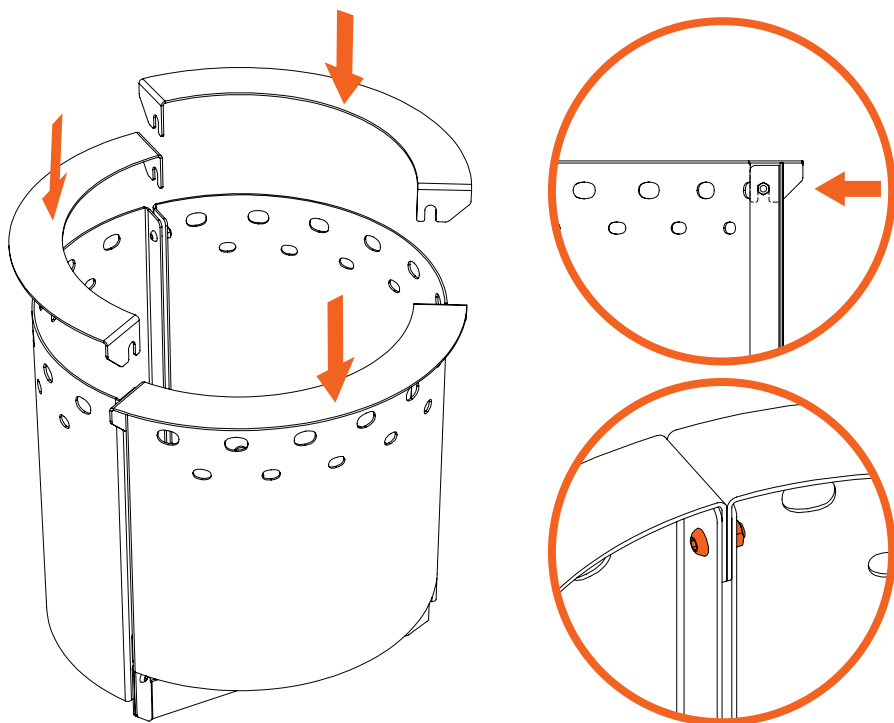

12

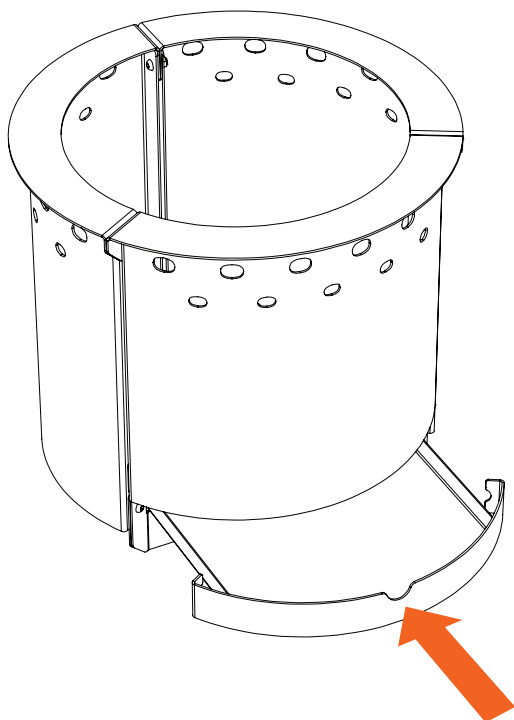

13

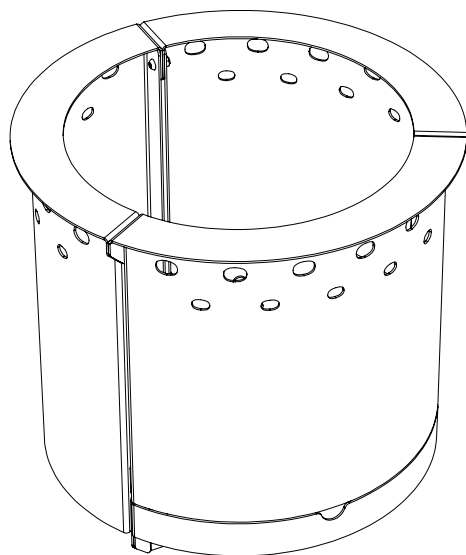

WARRANTY

The benefits provided to you under the following warranty are in addition to any other rights and remedies available to you under the law.

1. Warranty

If during the first year from the date of purchase (Warranty Period), there is a defect in the fire pit or included accessory (Product(s)), due to improper workmanship or material, Glen Dimplex will replace or repair the product without charge. Any replacement product is warranted only for the time remaining on the original Warranty Period or the Parts Warranty Period as relevant.

2. Registration

You must register to receive the benefit of this warranty by completing the warranty registration on our website (<https://www.masportheating.com.au/en-au/support/warranty>) within 30 days of purchase of your product.

3. Exclusions

Glen Dimplex is not obliged to replace or repair the Product under clause 1 if:

(a) it has been improperly stored, installed, assembled, used, operated or repaired, or damaged, abused, tampered with, altered (without our written approval), or not maintained in strict accordance with our installation and operating instructions; or

(b) it has been used for any purpose not considered domestic in nature.

4. Limit of Liability

The warranty provided under this warranty is limited to replacement or repair of the Product only, at our option. To the extent permitted by law, Glen Dimplex excludes liability for consequential loss or any other loss or damage caused to property or persons arising from any cause whatsoever, and damage arising from normal wear and tear.

5. Claiming under the Warranty

In order to claim under this warranty you must, within the Warranty Period or the Parts Warranty Period (as relevant), contact Glen Dimplex, providing the original proof of purchase and the details below:

Supplier Name _____

Date Of Purchase _____

Model / Serial Number _____

This warranty does not cover the cost of claiming under the warranty or transporting the Glen Dimplex Product to and from the supplier.

Our goods come with guarantees that cannot be excluded under the Australian Consumer Law. You are entitled to a replacement or refund for a major failure and for compensation for any other reasonably foreseeable loss or damage. You are also entitled to have the goods repaired or replaced if the goods fail to be of acceptable quality and the failure does not amount to a major failure.

If you would like to speak to someone about your Product or claiming under this warranty, please contact the Service Warranty Desk on 1300 554 155.

Glen Dimplex Australia Pty Ltd

ACN 69 118 275 460

Head Office: 8 Lakeview Drive, Scoresby 3179

Telephone: (03) 8706 2000

Facsimile: (03) 8706 2001



Glen Dimplex Australia Pty Ltd

8 Lakeview Drive,
Scoresby Victoria 3179
Australia

T: 1300 556 816 | F: 1800 058 900

General and Sales Enquiries: flame.care@glendimplex.com.au

Technical Service: flame.support@glendimplex.com.au

www.glendimplex.com.au